

STEEL-FIX MULTIGRIP RIVETS

Wide grip range (Reduces inventory). Outstanding hole fill in drilled or reworked holes. Positive mandrel retention. Weatherproof to 0.25 bar. Neat appearance on rear side.

Material: Body: Low Carbon Steel - SAE 1006
Mandrel: Carbon Steel
Finish: Body: Zinc Plated - Clear Passivation
Mandrel: Zinc Plated - Clear Passivation

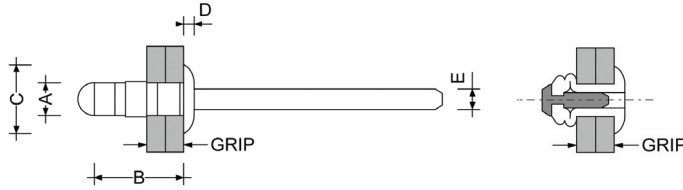
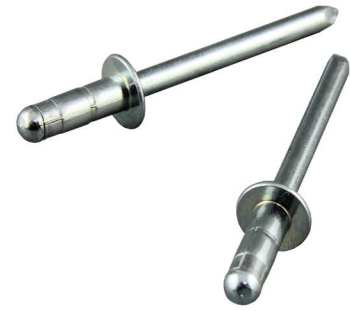

Diameter mm	Part Code	Grip mm	Hole mm	A mm	B mm	C mm	D mm	E mm	Shear KN	Tensile KN
Dome Head - Steel / Steel										
4.8 3/16"	AV24-0612	1.2-4.8	4.9	4.8	10.3	9.8	1.75	3.38	3.6	3.3
	AV24-0616	4.0-6.3	4.9	4.8	12.7	9.8	1.75	3.38	4.6	3.5
Low Profile Head - Steel / Steel										
3.2 1/8"	AV25-0403	1.0-4.0	3.3	3.2	9.0	7.2	0.85	2.10	1.5	1.7
	AV25-0406	1.0-9.0	3.3	3.2	13.0	7.2	0.85	2.10	1.5	1.7
4.0 5/32"	AV25-0503	1.4-5.0	4.1	4.0	11.0	8.1	1.20	2.73	2.0	2.4
	AV25-0505	1.4-8.0	4.1	4.0	14.0	8.1	1.20	2.73	2.0	2.4
4.8 3/16"	AV25-0614	1.0-6.0	4.9	4.8	11.0	9.8	1.45	2.90	4.4	3.8
	AV25-0618	1.0-9.0	4.9	4.8	14.0	9.8	1.45	2.90	4.4	3.8
	AV25-0622	3.0-12.0	4.9	4.8	17.0	9.8	1.45	2.90	4.4	3.8

Dimensions and specifications are subject to change without notice. Check your distributor for the latest data sheet.
The test data provides approximate strength values averaged in multiple tests in various materials and thicknesses.
We recommend testing your application when an exact strength figure is required, or the load to be applied comes close to the published data.

0413